



# HGS (INDIA) LIMITED

## HGS-5515 Male & Female push fit connectors



158, Sector-4, IMT Manesar, Gurgaon-122050 Haryana INDIA  
Tel: +91 (0124) 4681800, Fax: +91 (0124) 4681845  
Email: [sales@hgsindia.com](mailto:sales@hgsindia.com)



# HGS (INDIA) LIMITED

## SCHEMATIC

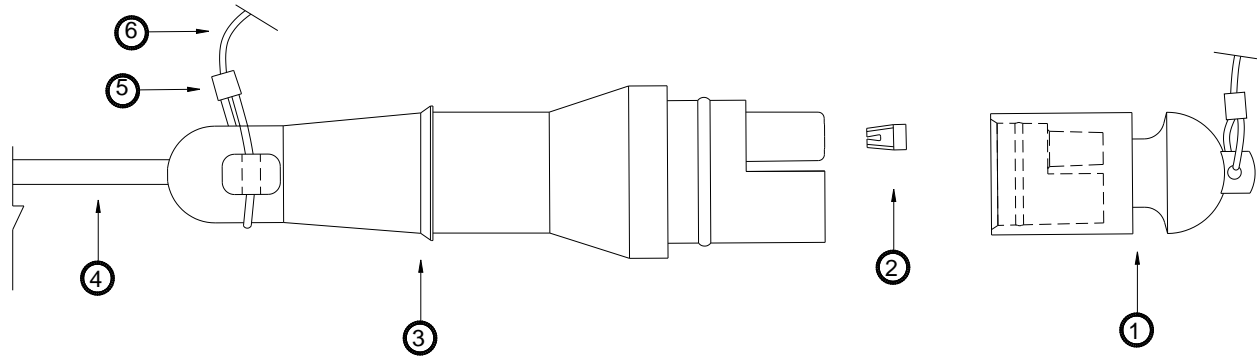

SR. NO.	DESCRIPTION	QTY.
1	DUST CAP (HGS-5515)	1
2	MILL-MAX #08	1
3	CONN. BODY SUB ASSY.(HGS-5515M RC)	1
4	CABLE	As reqd.
5	CRIMP SLEEVE	2
6	INSULATED WIRE ROPE	30CM

## HGS-5515 Male push fit connector



# HGS (INDIA) LIMITED

## SPECIFICATIONS

### HGS-5515 Male push fit connector

- Connector with 1 set of male & female contacts
- Impact Resistant Material. Can be provided for cold weather use.
- Moulded on 4.57, 5.33 or 6.35 mm cable
- Water proof for marsh environment
- Gold plated pins & sockets assure positive electrical connections
- Push-pull fit
- Maximum strength in rugged field condition
- Fitted with female dust cap
- Specific configuration to customer specifications
- Operating Temperature Range: -20°C to +70°C
- Pressure Rating: Up to 5 bar



# HGS (INDIA) LIMITED

## SCHEMATIC

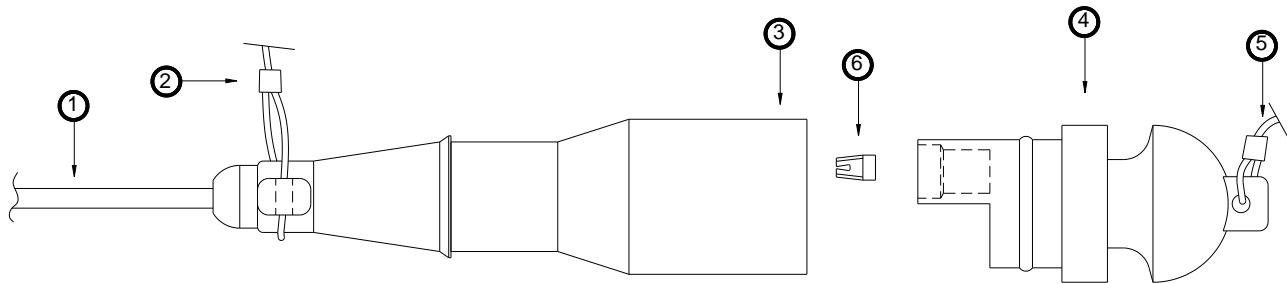

SR. NO.	DESCRIPTION	QTY.
1	LEADER CABLE	as reqd.
2	CRIMP SLEEVE	2
3	CONN. BODY FEMALE SUB ASSY.	1
4	MALE DUST CAP (HGS-5515)	1
5	INSULATED WIRE ROPE	30.5cm
6	MILL-MAX#08	1

## HGS-5515 Female push fit connector



# HGS (INDIA) LIMITED

## SPECIFICATIONS

### HGS-5515 Female push fit connector

- Connector with 1 set of male & female contacts
- Impact Resistant Material. Can be provided for cold weather use.
- Moulded on 4.57, 5.33 or 6.35 mm cable
- Fitted with male dust cap
- Push-pull fit
- Maximum strength in rugged field conditions
- Water proof for marsh environment
- Gold plated pins & sockets assure positive electrical connections
- Specific configuration to customer specifications
- Operating Temperature Range: -20°C to +70°C
- Pressure Rating: Up to 5 bar